

D-502 - Envision Series Mull Instructions

Required Tools:

- Tape Measure
- Hammer
- Phillips Screwdriver
- 5/32" Drill Bit
- Sealant Gun
- Silicon Sealant "Window and Door"
- Utility Knife
- Rubber Mallet
- Marker or Pencil
- Rotary Cutting Tool
- Personal Protective Equipment

Parts List:

- A. Flashing Tape TAP060
- B. SCR592
- C. SCR510
- D. MULL COVER
- E. MULLSTRAP
- F. Silicone – Not Supplied
- G. Aluminum mull bar (ENVMBAR)

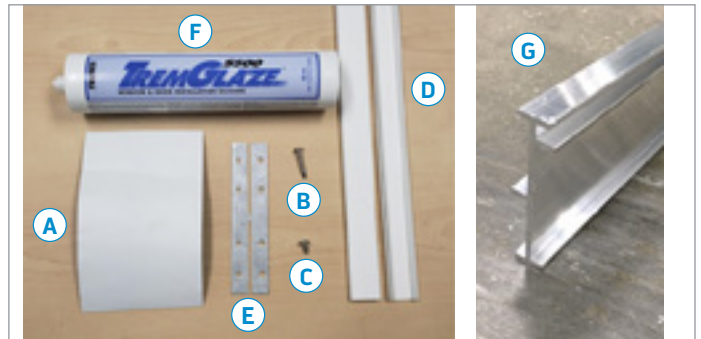

1. 1. Prepare the windows:

A. Lay out windows on a flat surface with interior side up in the intended mulling position. Place a mark on the nail fins that need to be removed where the mull joint will be.

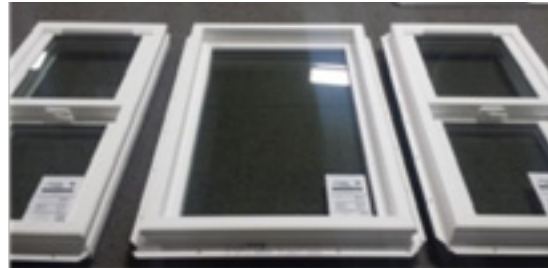

B. Remove marked nail fin(s) by scoring with a utility knife. Bend the fin down then up to remove the fin from the frame.



C. Where the nail fin was removed, square up the corners by removing excess vinyl weld from each corner. Do this for each end, interior and exterior of the window.



D. Use rotary tool to remove the end of the accessory track for the mull cover to snap into. Flip window over and do the exterior of window also. You may have to remove the whole corner if there is an intersecting mull at that corner or receiver is applied.

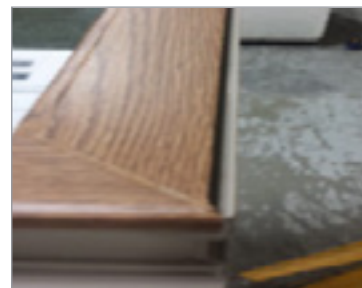

*Also, if window is wrapped in a laminate, interior or exterior, you will need to cut the laminate out of the accessory track using a utility knife.

2.

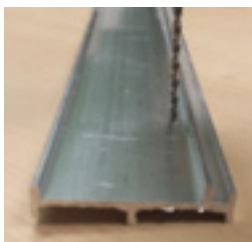

Casement



Glider and Hung

2. Interior Mullion Assembly

A. Pre-drill two 5/32" holes in the aluminum mull bar (ENVMBAR) about 6" to 12" from each end.

»-Verify drill locations for each window type, make sure screw will not go through frame.

»-Note: Longer windows may require a third hole in the center.

D-502 - Envision Series Mull Instructions



Casement



Glider and Hung

B. With interior side up. Place mull bar against window by setting the middle lip on the window and centered along length. Fasten to window using screws SCR592 into pre-drilled holes. If possible, attach to a non-operating window.



C. Align the second window to the first window with the mull bar.

D. Place MULL COVER over the two windows and align to the edge of the windows. Using a mallet, start by seating the cover into the accessory grooves about 6" in from the end, then work your way back and down the windows.



*If there is an intersecting mull, fill intersection with silicone before applying cover



E. Fill both ends with silicone. Start by inserting the tip all the way between the mull bar and the mull cover. Then, force silicone up into the gap and backfill to the outside.

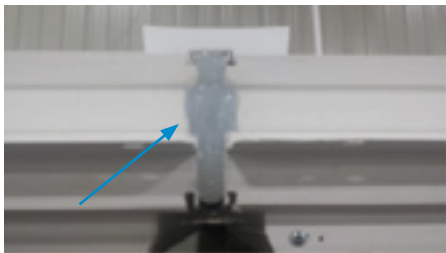

»-Then fill the rest of the cavity the same way all the way down to the bottom side of the mull bar.

F. Apply flashing tape (TAP060), start with about 6" to cover the end and the silicone. Use a wood block to work the tape into all corners as you apply the tape. Continue to wrap the tape down and around the nail fin to the exterior side of the window.



F



»-Trim tape even with exterior.



G. Place the "MULLSTRAP" centered on the end of the mull over the tape and attach with four SCR510 screws.

*MULLSTRAP may need to be split into two pieces.



3.

3. Exterior Mullion Assembly
A. Carefully turn the window over to work on the exterior side. Exterior Mullion Assembly

B. To seal the outside of the mull. Apply a small bead of silicone the full length of the window in each corner where the mull bar meets the vinyl.

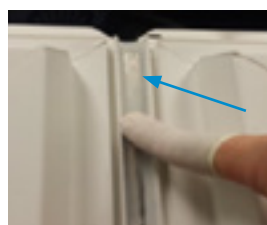

»-Using glove or finger cot, tool silicone smooth across mull bar and into corners.



»-If there is an intersecting mull, first fill cavity full of silicone, then down each side of the mull channel. Also, fill accessory groove about 1" in each direction. Finally, tool/smooth silicone in all directions.



C. Attach mull cover(s) the same way as the interior side.

D. Clean up an excess silicone and wipe down any other marks.

E. Remember to add any extra accessories that are required.